

AOP-Supreme Pallets

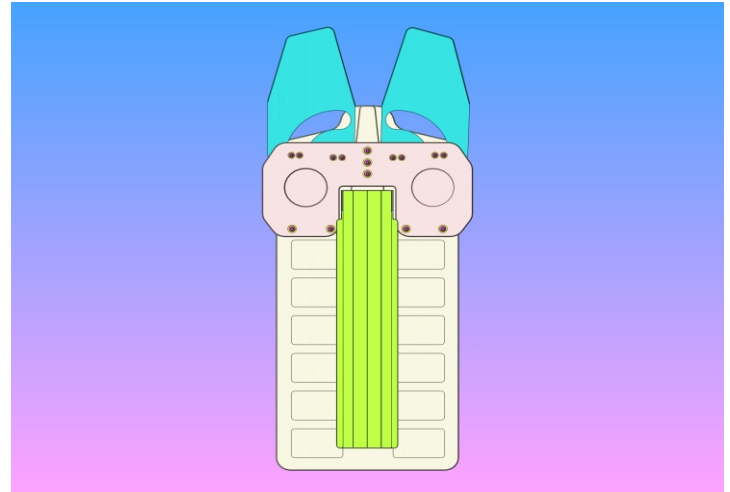

All-Over-Pallets allow you to accomplish a registered multi-color print on the entire surface of a shirt. From the far edge of the right sleeve to the far edge of the left sleeve and down to the hem of the body, you have complete access and control over where to print.

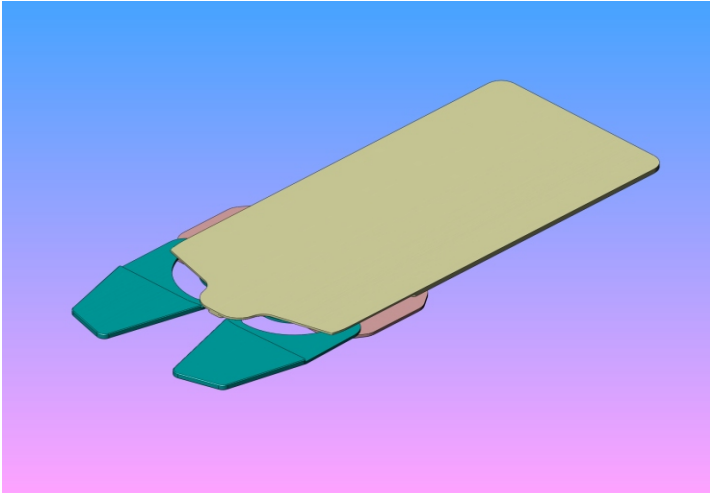

How to Load

With the wings pivoted forward, the shirt can be loaded. Then, the operator reaches into the sleeves of the shirt and feels for the pallet wings. As the wings are being pivoted down to the body, the operator is smoothing the sleeves onto the wings. Once the wings are located down, the shirt is now ready for its All-Over-Print

All-Over-Pallets are made using 3/8" solid aluminum jig and tooling plate material and do not have rubber. They are machined extensively for weight reduction and performance. We have them available in a full range of sizes to accommodate the entire standard shirt size range.

We are continuing to develop additional sizes and specifications of this pallet. For size details please contact us directly.

A main goal with our latest AOP design was to eliminate the need for a floor support assembly. That is an apparatus which provides deflection resistance to the pallets sleeve wings. We did accomplish this and now, All-Over-Printing is more productive and less costly than ever before.

Available for use on almost all manual & automatic textile printing machines

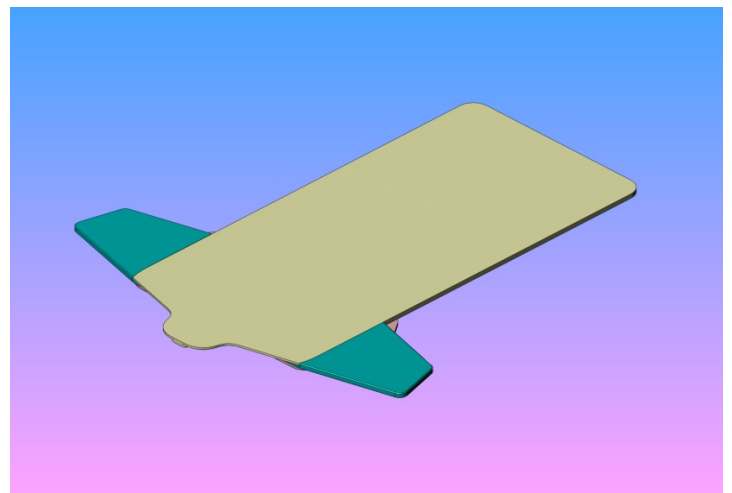

Distributed By: