

# Manual Machine Pallets



## Solid Aluminum & Soft Top Rubber Pallets

### Purpose & Features

These are the best pallets money can buy for your Workhorse, Hopkins, or almost any other brand of machine. Made using Solid Aluminum & Soft Top Rubber, these pallets outperform all others and are ready to ship.

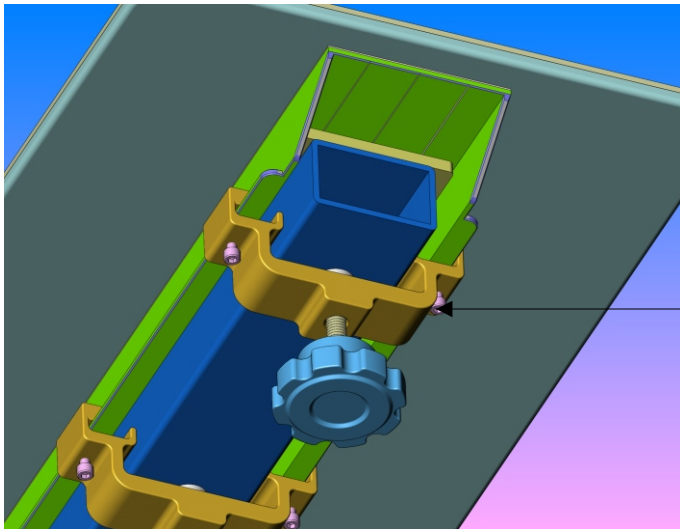

Solid 1/4" Aluminum & 1/8" Blemish Free Soft Top Rubber. It's the perfect combination of materials and an accepted industry standard. The aluminum hold up to heat and other factors many years longer than all other materials that are being used. The addition of the soft top rubber adds even more benefits.

These very special adapters allow you to use your M&R® Style Pallets on most manual machines. They work with all machines which use a rectangular bar as shown below. Workhorse, Hopkins, and many other popular manual machines now have the ability to accept the pallets from your automatic. The bar dimensions can be 2.5" wide up to 3" wide. They also work with Progressive Machines and the Anatol Slide Style Brackets

The addition of Soft Top Rubber to the pallets provides many advantages. Better print control, faster flash times, and less hand pressure are just a few.

**Our pallets are height matched to your originals. There is no off contact change.**

### Available Sizes

10 X 16 Aluminum & Rubber
12 X 16 Aluminum & Rubber
14 X 16 Aluminum & Rubber
15 X 16 Aluminum & Rubber
15 X 18 Aluminum & Rubber
16 X 18 Aluminum & Rubber
18 X 20 Aluminum & Rubber

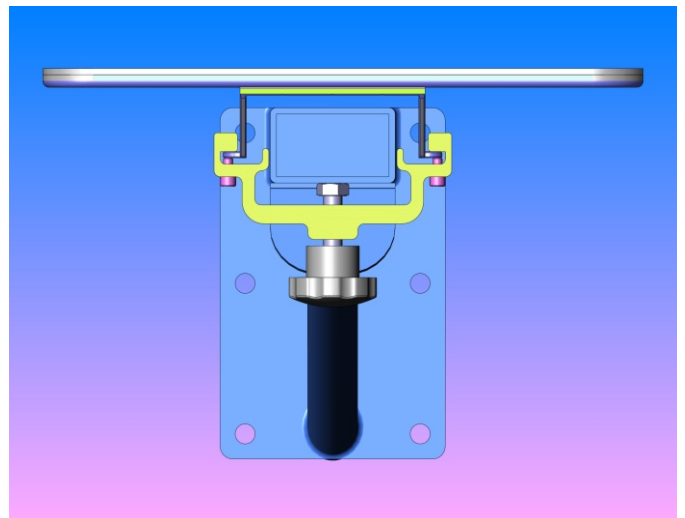

**Distributed By:**