

Placket Shirt Pallets



- ⊕ Pallets
- ⊕ Squeegees
- ⊕ Floodbars



For printing on placket shirts, a.k.a. button down, collared golf shirts. Available in standard and custom pallet sizes for use with almost any manual or automatic textile printing machine.

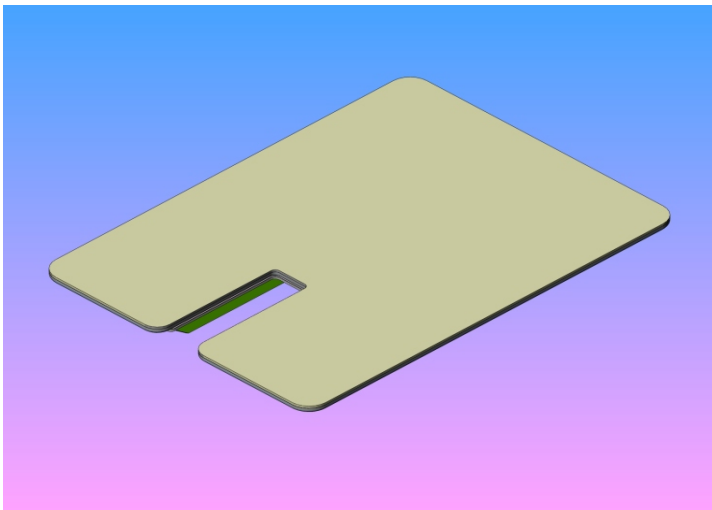

This Placket Pallet has a standard slot of 2" x 7". The measured typical button/ hem seams are 1.75" (45 mm) wide. If you're printing placket shirts now, or plan to, than this is the very best pallet product for this application.

Available for use with most Manual Machines

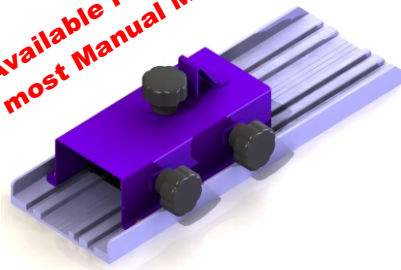

Available for use with Anatol Machinery



You can easily print on the entire surface of your Collared Golf Shirt. The button and hem assembly drop into the slot to eliminate squeegee interference. From the top of the shoulder down is accessible.

Available Sizes

12" x 22"
14" x 22"
16" x 22"
18" x 22"
20" x 22"

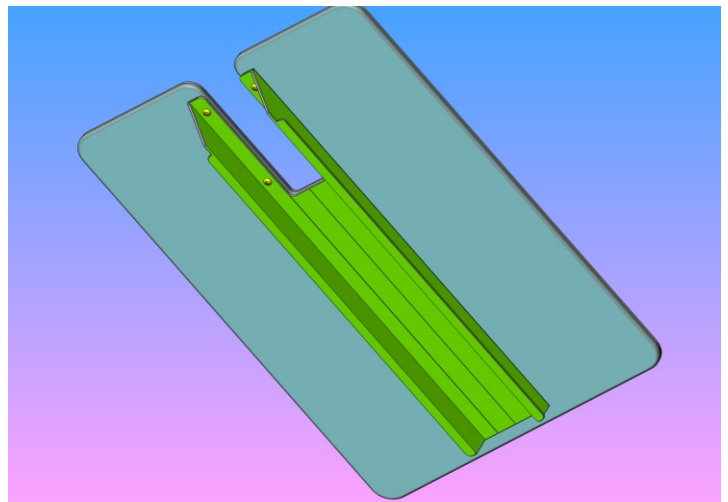

Distributed By: